

PORTAL CS ALU

Sliding door hardware
for aluminium elements

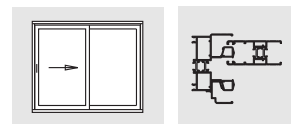

... with the key benefits:

- Simple locking part on the locking side
- Simple adjustment on frames thanks to special striker plate
- Elegant, ergonomic recessed sliding handle

Size range

Sash rebate height	(mm)	according to specifications of the profile manufacturer
Sash rebate width	(mm)	according to specifications of the profile manufacturer
Sash weight	(kg)	max. 100

The size range mentioned above must not be exceeded.

In addition, the specifications of the profile manufacturers or system owners also apply for the SIEGENIA CS PORTAL LM hardware, **especially** with regard to possible restrictions on permissible sash dimensions and/or sash weight.

Table of contents

Size range.....	page 1	CS LM 100 bogie wheels technical data sheet.....	page 5
Hardware overview	page 2	Installing the recessed handle	page 6
Hardware list	page 3	Important information, abbreviations.....	page 7
Sash and frame dimensions.....	page 4	Striker plates and locking hooks	page 8

Assembly instructions
H48.CSLMS0001EN-00

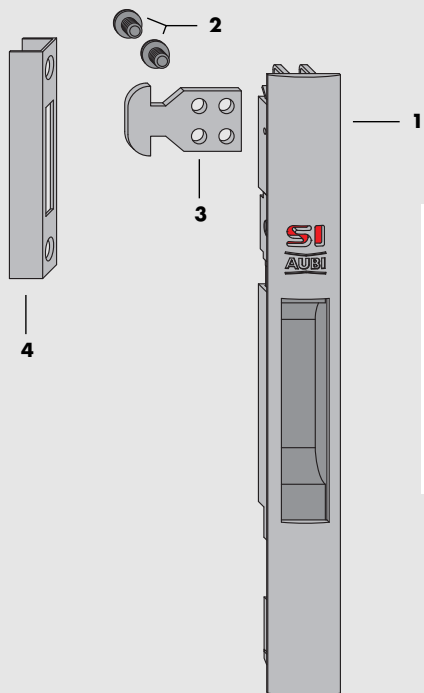

- 1** CS LM recessed handle
- 2** Screws
- 3** CS LM locking hook
- 4** CS LM striker plate
- 5** CS LM 100 bogie wheels

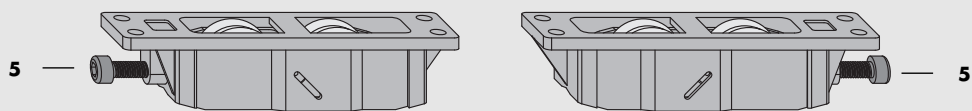

Bogie wheels: see technical data sheet on page 5

PORTAL CS ALU with recessed handle Hardware list

	Item	Qty	Material description	Material number		
				White RAL 9016	Black RAL 9005	Si-silver
Gen. requirements		1	CS LM recessed handle <i>consisting of:</i>	PHIM0010-004010	PHIM0010-023010	PHIM0010-025010
	1	1	CS LM recessed handle			
	2	2	Screws <i>for fixing the locking hook</i>			
profile-specific	3	1	CS LM locking hook Design A0272 Design A0274 Design A0275 Design A0276		PFZM0010-000010 PFZM0020-000010 PFZM0030-000010 PFZM0040-000010	
	4	1	CS LM striker plate Design A0272 Design A0274 Design A0275 Design A0276		PRTM0010-000010 PRTM0020-000010 PRTM0030-000010 PRTM0040-000010	
	5	2	CS LM 100 bogie wheels Sash weight max. 100 kg		PLWM0010-099010	

Note: This hardware list relates to schemes with one sliding sash

Fixing the hardware components

- CS LM recessed handle (**1**): clamping device
 - CS LM 100 bogie wheels (**5**): B 4.8 x .. self tapping screw
 - CS LM striker plate: B 4.8 x .. countersunk tapping screw
- B 4.8 x .. screws, steel, clear zinc-coated (not included in the scope of delivery)
Screw lengths depending on the profile system.

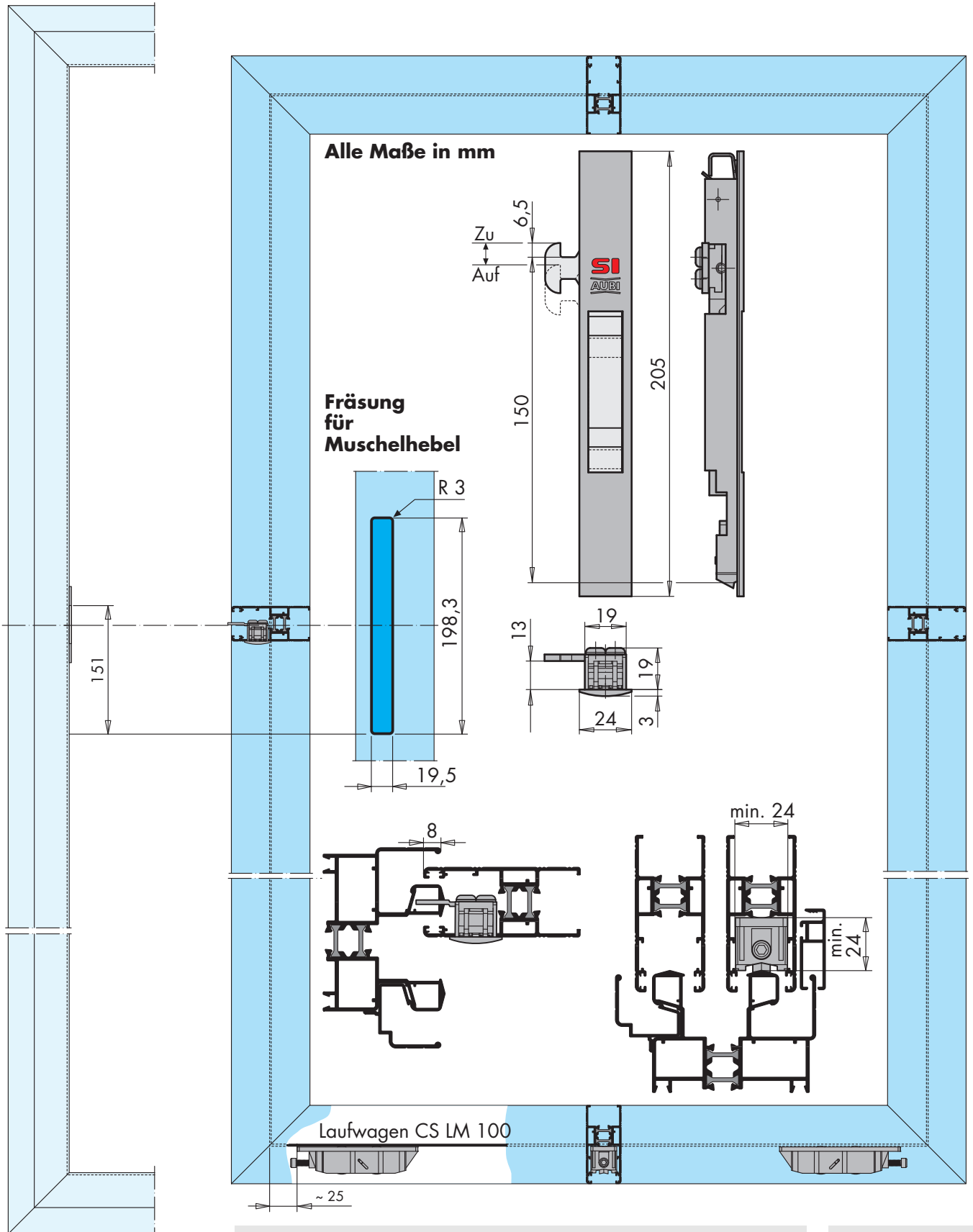

Assembly on frame

Screw on the CS LM striker plate (4) so that it is true to size and functional.

Assembly on window sash

- A** Mill the cutout for the CS LM recessed handle (1).
- B** Insert the CS LM recessed handle (1), push upwards and snap in at the bottom.
- C** Insert the CS LM 100 bogie wheels (5) into the sliding sash and fix with screw.

Final assembly

- A** Insert sliding sash into the frame.
- B** Check the function.

Sämtliche Maße in mm

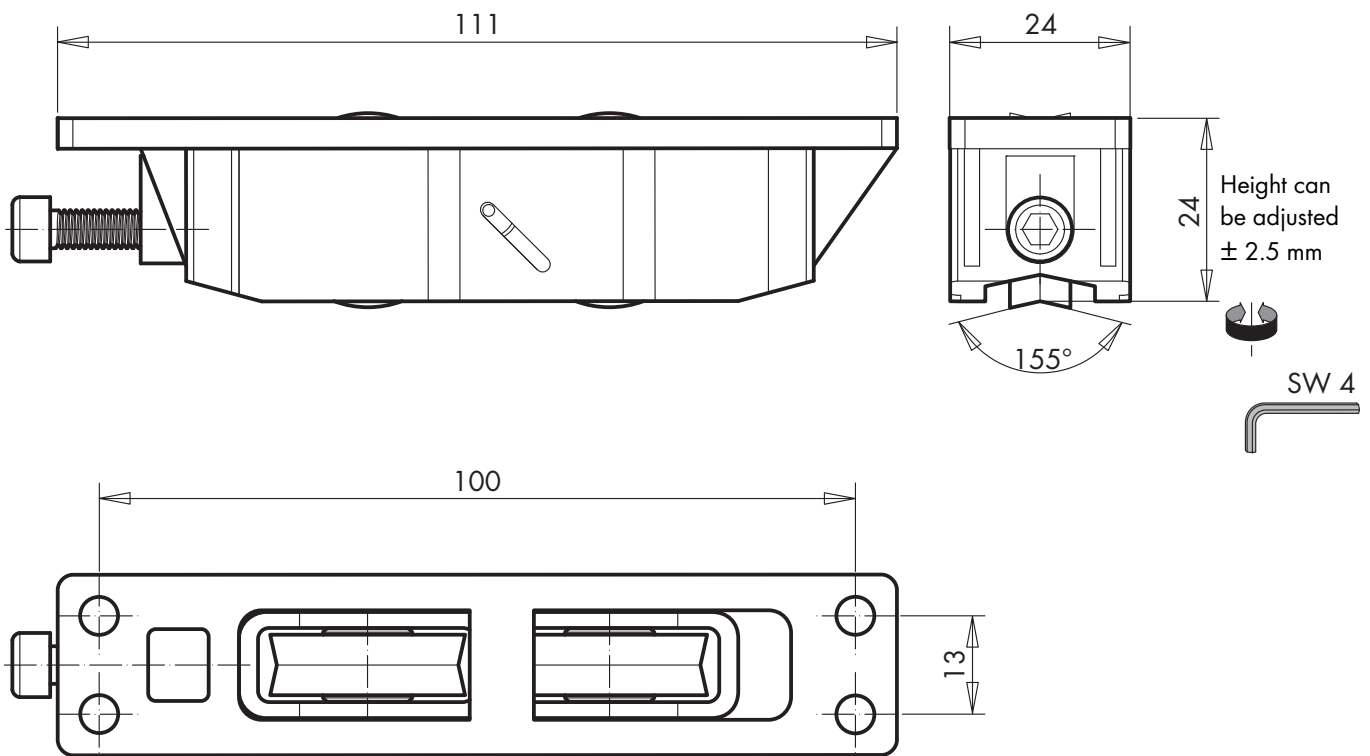

B 4.8 x ... self tapping screw to be provided by customer.

- For running rails with 155° roller angle
- Load capacity max. 100 kg/pair of bogie wheels
- Ball-bearing rollers

PORTAL CS ALU with recessed handle *Installing the recessed handle*

1. Insert the recessed handle in the milling groove.
2. Push the recessed handle upwards in the milling groove.
3. Push the recessed handle into the milling groove.

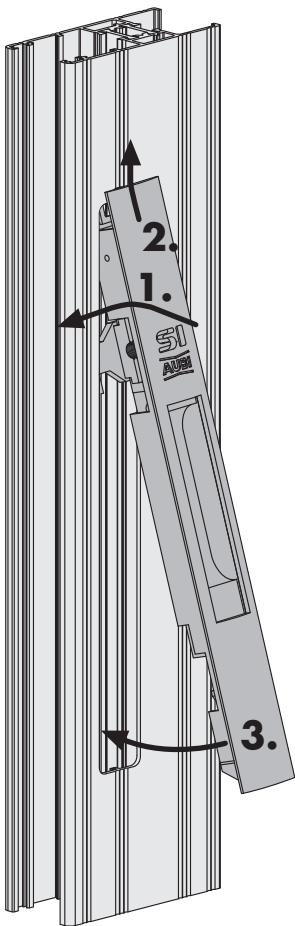

4. Push the recessed handle downwards in the milling groove.



Important information

- Please observe our "Sliding hardware for French door and window sashes" product information.
- The size ranges given for the PORTAL CS LM hardware from SIEGENIA on page 1 must not be exceeded.
Furthermore, the specifications of the profile manufacturers, in particular with regard to potential limitations in sash dimensions and sash weight, apply to the PORTAL CS LM hardware from SIEGENIA. The specifications given for torques must be adhered to.
If special manufacturing instructions or fabrication guidelines exist, these must be explicitly observed.
The hardware components described in these assembly instructions are manufactured from steel, zinc plated and then treated with a special process.
They may not be used:
 - in damp rooms
 - in environments with aggressive, corrosive air
 - in environments with salty air
- In such cases, please contact your SIEGENIA sales representative
- Assemble your complete set of hardware **only** from SIEGENIA hardware components and the prescribed accessory parts from the profile manufacturer.
Otherwise damage could occur, for which we accept no liability.
- All hardware components must be properly assembled as described in these assembly instructions. **Do not overtighten the screws!**
- When block setting, please observe technical guideline no. 3 from the German Glazing Trade [Glaserhandwerk], "Blocking glazing units" [Klotzung von Verglasungseinheiten].
- Never use acid curing sealants as they may cause the hardware components to corrode.
- Keep the runners of the guide rail or the threshold and all rebates free from debris and contamination - in particular, free from cement or residues of plaster.
Avoid exposing the hardware directly to water and do not let cleaning agents come into contact with the hardware.

Disclaimer of liability

We assume no liability for any loss of function or damage to the hardware or to the fitted sliding elements resulting from insufficient tendering, failure to follow these assembly instructions or force being applied to the hardware (e.g. through improper use).

We assume no liability for loss of function or damage to the hardware (or to the fitted sliding elements) if:

- assembly is not undertaken in accordance with our assembly instructions and generally recognised technical standards and regulations;
- the hardware is damaged through the application of force, misuse or external influences;
- unauthorised modifications have been made to the hardware;
- hardware components originating from other ranges or other manufacturers, which have not been approved, are also used; this also applies to hardware component combinations with different surface finishes that have not been approved;
- the hardware is not subjected to maintenance in accordance with our CS PORTAL maintenance instructions at least once a year;
- the end customer has not been informed of our maintenance instructions and given appropriate instruction.

We explicitly wish to point out that the hardware components must be cleaned at regular intervals; in particular, the guiding rail and running rail must be kept clean to ensure trouble-free use.

Abbreviations

The following abbreviations are used in these assembly instructions:

Bl.	Bag
FB	Sash width
FH	Sash height
RAB	Frame width
RAH	Frame height

PORTAL CS ALU Striker plates and locking hooks

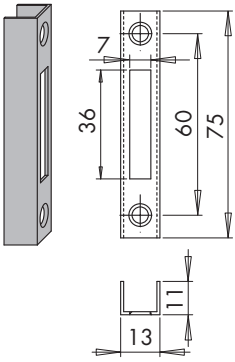

CS LM striker plate A 0272

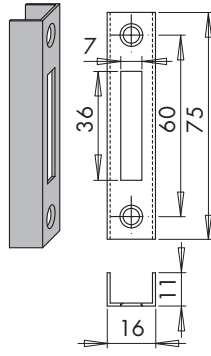

CS LM striker plate A 0274

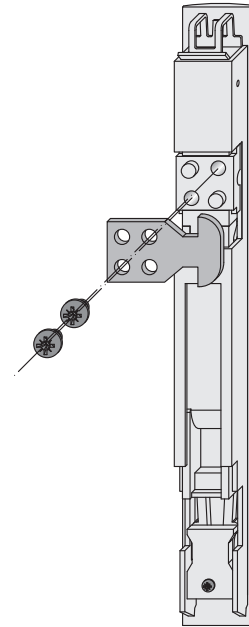

Fix the locking hook with the enclosed screws (2).

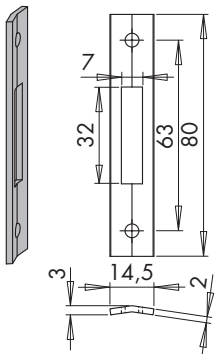

CS LM striker plate A 0275

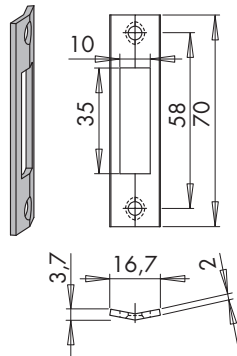

CS LM striker plate A 0276

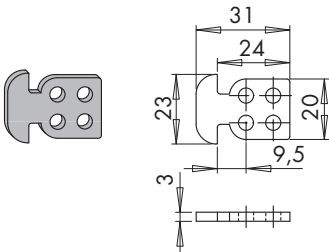

CS LM locking hook A 0272

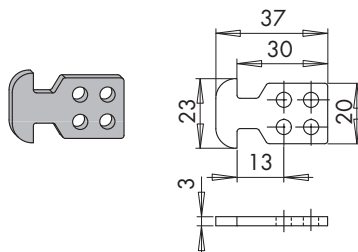

CS LM locking hook A 0274

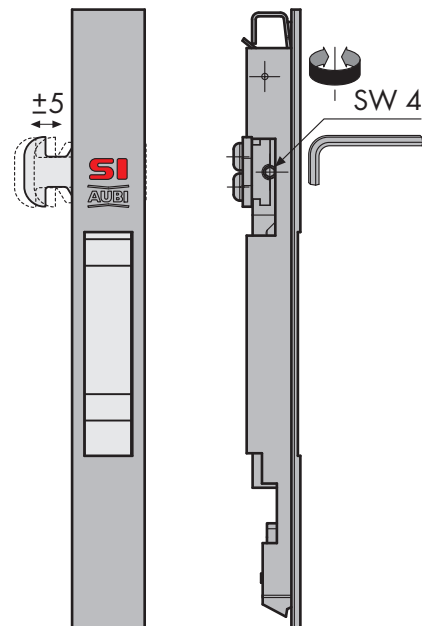

The locking hook can be adjusted with an SW 4 hexagon wrench.

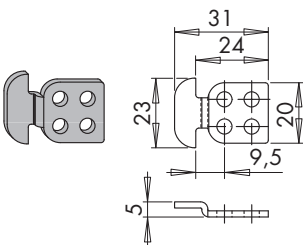

CS LM locking hook A 0275

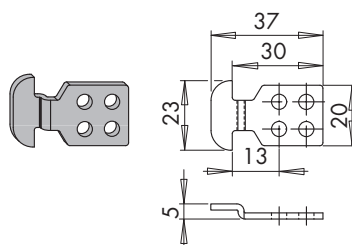

CS LM locking hook A 0276